

## MM1N1T0G

### MMCX Male Straight Connector, PCB THT

V1.10

#### Electrical Characteristics

- Impedance: 50 Ohm
- Insulation resistance:  $\geq 1000\text{M Ohm}$
- Dielectric Withstanding Voltage: 750V
- Center Contact Resistance.:  $\leq 5\text{ mohm}$
- Outer Contact Resistance:  $\leq 3\text{ mohm}$
- Working Temperature:  $-40^{\circ}\text{C} \sim +125^{\circ}\text{C}$



#### Material and Plating

Parts Name	Material	Plating
Body	HPb59-1	Au
Insulator	SFX-1-1	-
Center conductor	HPb59-1	Au

#### DIMENSIONS

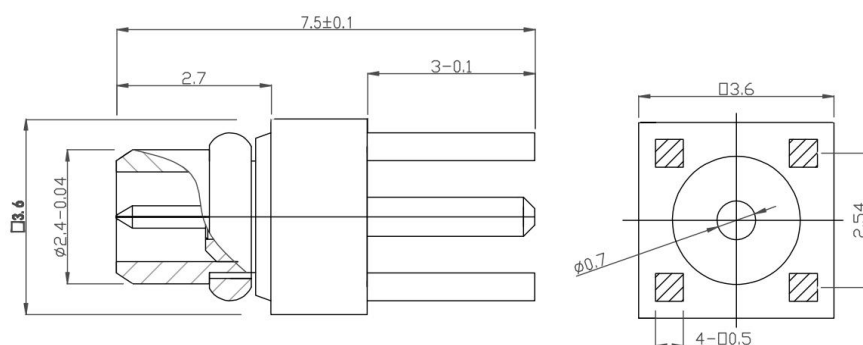

Figure 1: MM1N1T0G-CA

## NOMENCLATURE

### **MM1N1T0G --- C A 30**

①                      ②   ③   ④

Num	Symbol	Explanation
①	Connector Type	MMCX male straight connector, PCB THT mount
②	Internal Code	Factory production code
③	Variant	A, B ,C, D - differences in dimensions
④	Plating level	18, 30, 48 - larger number means longer plating time

Table 1: Explanation of Nomenclature

## ORDER INFORMATION

Part Number	Description
MM1N1T0G-CA30	MMCX male straight connector, PCB THT mount, Plating level: 30

Table 2: Order Information

**Dorji Industrial Group Co., Ltd** reserves the right to make corrections, modifications, improvements and other changes to its products and services at any time and to discontinue any product or service without notice. Customers are expected to visit websites for getting newest product information before placing orders.

These products are not designed for use in life support appliances, devices or other products where malfunction of these products might result in personal injury. Customers using these products in such applications do so at their own risk and agree to fully indemnify Dorji Industrial Group for any damages resulting from improper use.